

RURAL MUNICIPALITY OF LAKE LENORE NO. 399

SUBDIVISION MAP

GODART SUBDIVISION
NE 23-42-21-2

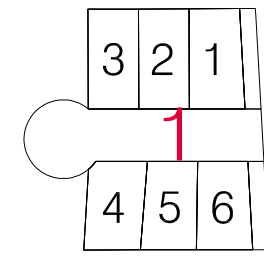

- LOT 1 BLOCK 1 - CALVIN & MARIA GODART
- LOT 2 BLOCK 1 - CALVIN & MARIA GODART
- LOT 3 BLOCK 1 - CALVIN & MARIA GODART
- LOT 4 BLOCK 1 - CALVIN & MARIA GODART
- LOT 5 BLOCK 1 - CALVIN & MARIA GODART
- LOT 6 BLOCK 1 - CALVIN & MARIA GODART

FORSTER SUBDIVISION
NE 23-42-21-2

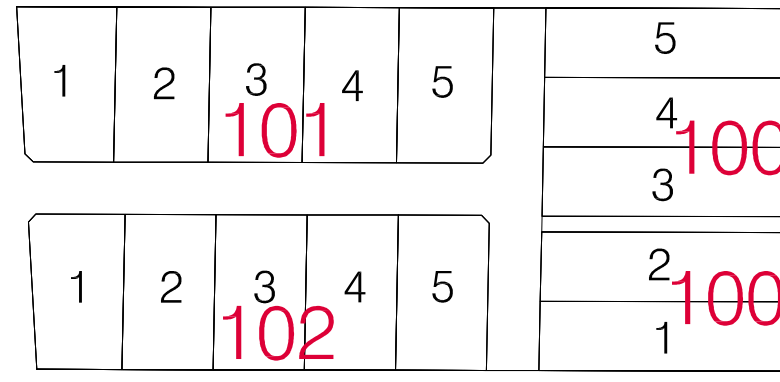

- LOT 1 BLOCK 100 - ZEMON & LORRAINE FORSTER
- LOT 2 BLOCK 100 - DAVID FORSTER, CAROL KIRBY, & ESTELLE & GREGORY FORSTER
- LOT 3 BLOCK 100 - RICHARD & COLETTE JOHNSON
- LOT 4 BLOCK 100 - LEE & MARLO MORELLI
- LOT 5 BLOCK 100 - HENRIETTE LLOYD
- LOT 1 BLOCK 101 - JOEL & KATHERINE PELLETIER
- LOT 2 BLOCK 101 - RANDY & TAMARA FRASER
- LOT 3 BLOCK 101 - WENDI & SEAN SPENCE
- LOT 4 BLOCK 101 - COLIN & PAMELA ALDORFER
- LOT 5 BLOCK 101 - R.S. INVESTMENTS CO. LTD.
- LOT 1 BLOCK 102 - JAMES MOORMAN & RENEE FRIESEN
- LOT 2 BLOCK 102 - TRI-QUEST CONSTRUCTION LTD.
- LOT 3 BLOCK 102 - GLEN & LORI ANN GRAHAM
- LOT 4 BLOCK 102 - KEY VENTURES INC.
- LOT 5 BLOCK 102 - DEAN, JANNIE, JOCELYNE, MICHAEL POSSBERG & TIMOTHY & JANNIE SCHMIDT

BOISSIERE SUBDIVISION
SE 23-42-21-2 &
NE 14-42-21-2

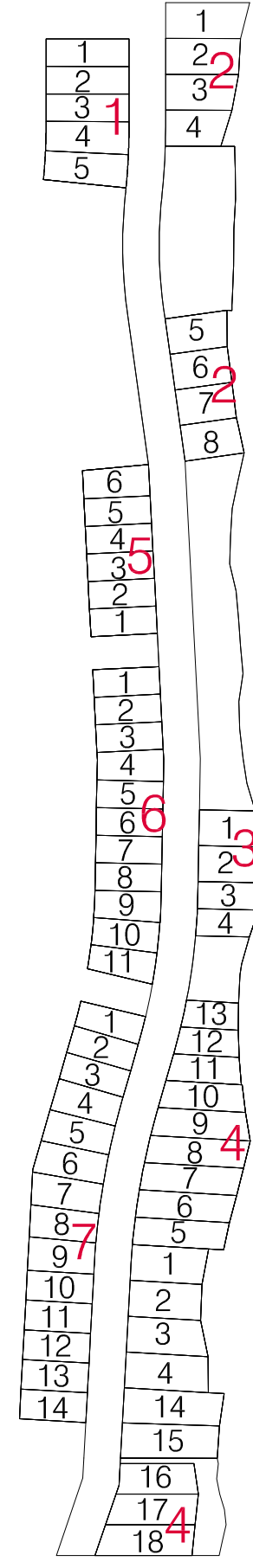

- LOT 1 BLOCK 1 - MARTIN & SHELLEY BETKER
- LOT 2 BLOCK 1 - GORDON & YVONNE EDDY
- LOT 3 BLOCK 1 - RICHARD & MARY NEKAMP
- LOT 4 BLOCK 1 - RICHARD & MARY NEKAMP
- LOT 5 BLOCK 1 - ADELE WELAR
- LOT 1 BLOCK 2 - EMILIE YOCKELL
- LOT 2 BLOCK 2 - MARTIN & SHELLEY BETKER
- LOT 3 BLOCK 2 - CURTIS & AMY MEEKINS
- LOT 4 BLOCK 2 - HAROLD & CAROLINE PAPPENFUS
- LOT 5 BLOCK 2 - KEN & SHELLEY MCKETSY
- LOT 6 BLOCK 2 - KEN & SHELLEY MCKETSY
- LOT 7 BLOCK 2 - ROBERT & PATRICK COQUET
- LOT 8 BLOCK 2 - PATRICK MASSINGER
- LOT 1 BLOCK 3 - CHRISTINE BEDARD & EMILE ROOCHER
- LOT 2 BLOCK 3 - DENIS & LORETTE MEVEL
- LOT 3 BLOCK 3 - DENIS & LORETTE MEVEL
- LOT 4 BLOCK 3 - MURRAY & JOAN HERGOTT
- LOT 1 BLOCK 4 - KENNETH & JOYCE ARN
- LOT 2 BLOCK 4 - KENNETH & JOYCE ARN
- LOT 3 BLOCK 4 - JAMES & DELIAH BOYLE
- LOT 4 BLOCK 4 - JAMES & DELIAH BOYLE
- LOT 5 BLOCK 4 - RONALD & SHEILA WILLIAMS
- LOT 6 BLOCK 4 - RONALD & SHEILA WILLIAMS
- LOT 7 BLOCK 4 - CALVIN & KAREN CARPANTAN
- LOT 8 BLOCK 4 - DANIEL & KATHERINE KOLBECK
- LOT 9 BLOCK 4 - ROBERT & DONNA HEINRICH
- LOT 10 BLOCK 4 - HANS & CATHERINE KNOOP
- LOT 11 BLOCK 4 - HANS & CATHERINE KNOOP
- LOT 12 BLOCK 4 - REGAN ULSKI & JIA LIU
- LOT 13 BLOCK 4 - COLLEEN & HAROLD JENKINS & JOHN & JILL LEES
- LOT 14 BLOCK 4 - DOROTHY COQUET
- LOT 15 BLOCK 4 - RODNEY & JANE PEARSON
- LOT 16 BLOCK 4 - DENIS FERRE & DANIELE EMARD-FERRE
- LOT 17 BLOCK 4 - PALETTE BOULANGER
- LOT 18 BLOCK 4 - SHAWN & LORNA MCGRATH
- LOT 1 BLOCK 5 - DONALD & SYLVIA MILLER
- LOT 2 BLOCK 5 - DONALD & SYLVIA MILLER
- LOT 3 BLOCK 5 - MIKE & BERNICE KOVAL & LOUISE KOVAL-MASSINGER
- LOT 4 BLOCK 5 - MIKE & BERNICE KOVAL & LOUISE KOVAL-MASSINGER
- LOT 5 BLOCK 5 - WILLIAM & ROSE ANN THES
- LOT 6 BLOCK 5 - WILLIAM & ROSE ANN THES
- LOT 1 BLOCK 6 - BARRY & DIANE FAIRBAIN
- LOT 2 BLOCK 6 - BARRY & DIANE FAIRBAIN
- LOT 3 BLOCK 6 - DEAN LOHAMMER & SHONNA JOHNSON
- LOT 4 BLOCK 6 - KETH & GAIL CASSIDY
- LOT 5 BLOCK 6 - RANDY & LYNN DOLL & JERRY JR. & BETTY DOLL
- LOT 6 BLOCK 6 - RANDY & LYNN DOLL
- LOT 7 BLOCK 6 - JEAN & MARILYN MEVEL
- LOT 8 BLOCK 6 - PATRICK MASSINGER
- LOT 9 BLOCK 6 - PATRICK MASSINGER
- LOT 10 BLOCK 6 - MURRAY & JOAN HERGOTT
- LOT 11 BLOCK 6 - DAVID & KIM FISHER
- LOT 1 BLOCK 7 - REGAN ULSKI & JIA LIU
- LOT 2 BLOCK 7 - ROGER & MARY-ANN POMEUL
- LOT 3 BLOCK 7 - ROGER & MARY-ANN POMEUL
- LOT 4 BLOCK 7 - DARC & DANNE KOVACS
- LOT 5 BLOCK 7 - ROBERT BOISSIERE
- LOT 6 BLOCK 7 - RODNEY & CHERYL TOLAND
- LOT 7 BLOCK 7 - SHEILA'S STATE OF THE ART HOMES & DESIGN LTD.
- LOT 8 BLOCK 7 - LORRAINE & LEONARD ZIMMER
- LOT 9 BLOCK 7 - KIMBERLY DONALD & RICHARD ULRICH
- LOT 10 BLOCK 7 - WAYNE & WENDY WELSH
- LOT 11 BLOCK 7 - VERN & WENDY YAWORSKI
- LOT 12 BLOCK 7 - JAMES & LEONA SMITH
- LOT 13 BLOCK 7 - KENNETH & CAROL DALKE
- LOT 14 BLOCK 7 - ANTHONY & RHONDA ORBENTWICH

LAKEVIEW SUBDIVISION
W 1/2 13-42-21-2

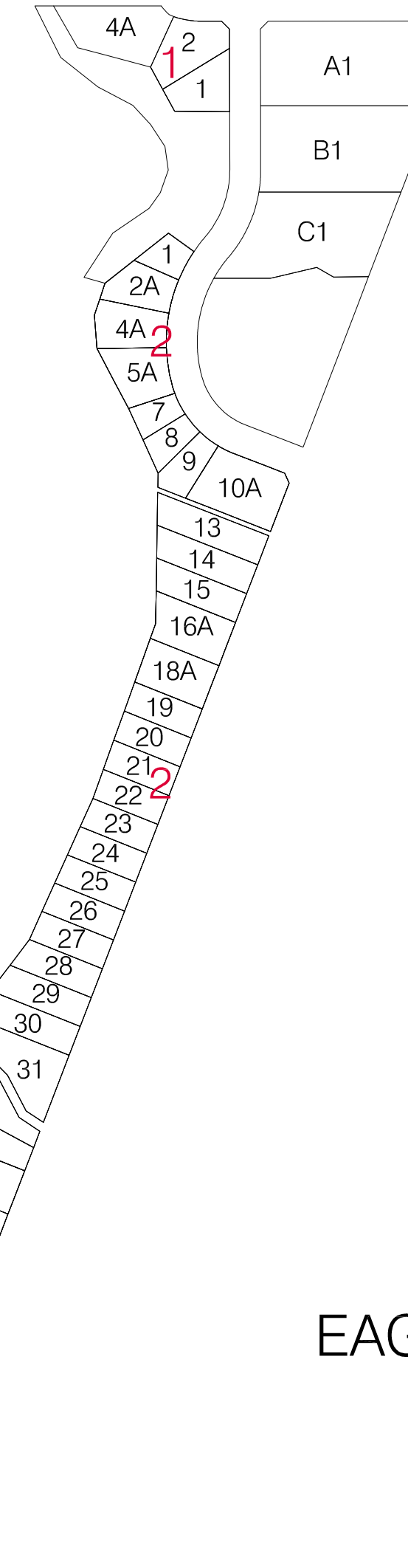

- LOT 1 BLOCK 1 - KEITH & DEANNA FOLDEN
- LOT 2 BLOCK 1 - JAMES & JEAN KOLBECK
- LOT 4A BLOCK 1 - JACQUELINE BOURGAULT
- LOT 1 BLOCK 2 - SHEILA'S STATE OF THE ART HOMES & DESIGN LTD.
- LOT 2A BLOCK 2 - JAG BUILDERS LTD.
- LOT 4A BLOCK 2 - MICHAEL & JANET GAUTHER
- LOT 5A BLOCK 2 - BRUCE & DENISE BORTS
- LOT 7 BLOCK 2 - DARRILL & BRENDA NYSTEN
- LOT 8 BLOCK 2 - GERALD & PATRICIA MILLER
- LOT 9 BLOCK 2 - SHEILA'S STATE OF THE ART HOMES & DESIGN LTD.
- LOT 10A BLOCK 2 - SHEILA'S STATE OF THE ART HOMES & DESIGN LTD.
- LOT 13 BLOCK 2 - ROBERT & YVONNE FONTAINE
- LOT 14 BLOCK 2 - CAM & BRENDA MICHACHEM
- LOT 15 BLOCK 2 - RANDY & CATHERINE SMITH
- LOT 16A BLOCK 2 - CAM & BRENDA MICHACHEM
- LOT 18A BLOCK 2 - ALLAN & PENNY STUCKEL
- LOT 19 BLOCK 2 - KERRY STUCKEL
- LOT 20 BLOCK 2 - TERRANCE LEONARD & SHERILL CARLSON
- LOT 21 BLOCK 2 - BEVERLEY & KIRK KEZEMA
- LOT 22 BLOCK 2 - SHELON & DEBBE LEICHT
- LOT 23 BLOCK 2 - MAURICE & PAULINE BOYER
- LOT 24 BLOCK 2 - SHAWN & GLORIA HENSCHEL
- LOT 25 BLOCK 2 - GARY & CHANTAL SHANER
- LOT 26 BLOCK 2 - DARRIN & JULIE YUNGMAN
- LOT 27 BLOCK 2 - KETH & GAIL STRAUFF
- LOT 28 BLOCK 2 - PAUL & LILIANE LERAY
- LOT 29 BLOCK 2 - BLACK WOLF ENGINEERING LTD.
- LOT 30 BLOCK 2 - CURTIS STUCKEL & CHRISTINE WILKINSON
- LOT 31 BLOCK 2 - GORDON & JUDY GLASSEN
- LOT 1 BLOCK 3 - BARRY BOESCHEN & PAMELA WATSON
- LOT 2 BLOCK 3 - DON GRAHAM & IRENE STEWARD
- LOT 3A BLOCK 3 - JIM & MONA GRAHAM
- LOT 5A BLOCK 3 - PAT & GWYN YEAGER
- LOT 6 BLOCK 3 - JOSEPH BOURGAULT
- LOT 8A BLOCK 3 - NORBERT & DONNA DUBE
- LOT 9A BLOCK 3 - NORBERT & DONNA DUBE
- LOT 11A BLOCK 3 - LINUS & CHERYL YEAGER
- LOT 12A BLOCK 3 - RYAN & JENNIFER PUETZ
- LOT 13A BLOCK 3 - MARC & JACKIE RHEAUME
- LOT 14A BLOCK 3 - GERALD SMITH & KAREN ABEL-SMITH
- LOT 15A BLOCK 3 - TIM & EILEEN BROOKS
- PARCEL A1 - MICHAEL & ANGELA WARNECKE
- PARCEL B1 - RICK & BEV SCHEMMEIJER
- PARCEL C1 - STEPHEN & JOSE HAYNES

WILLOW POINT SUBDIVISION
SW 14-42-21-2

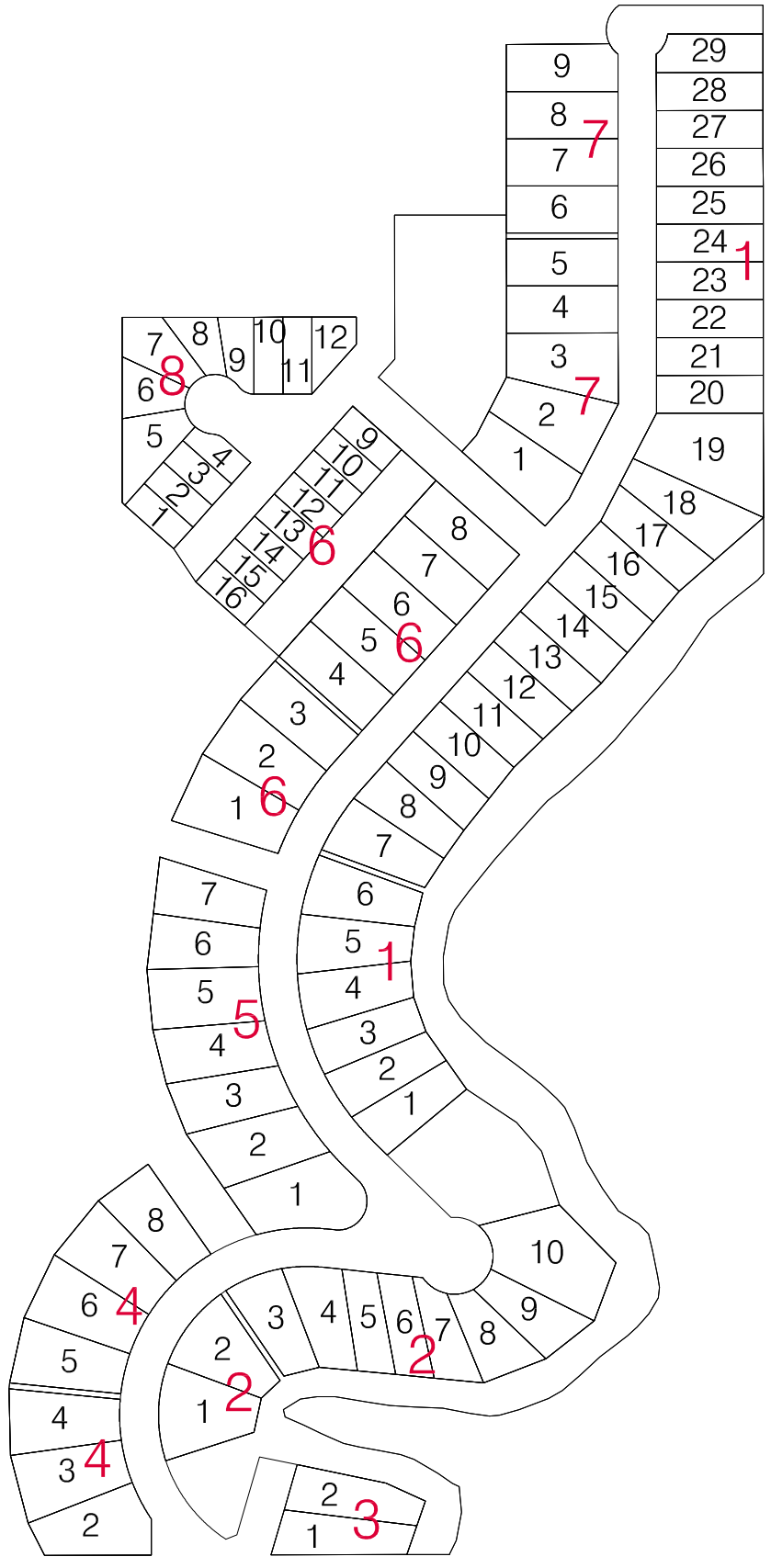

EAGLE LAKE SUBDIVISION
SW 25-42-19-2

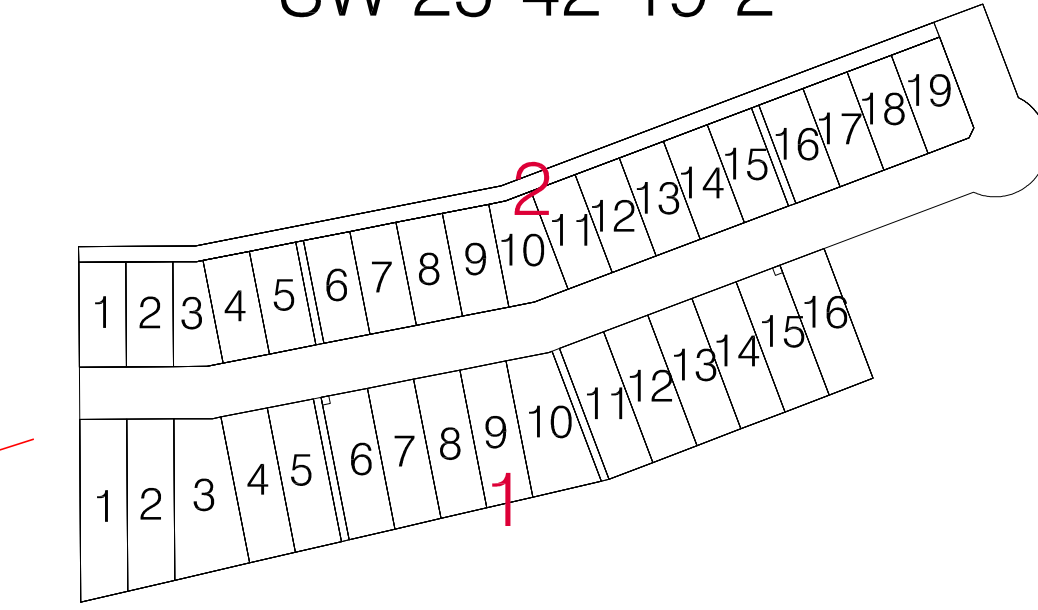

- LOT 1 BLOCK 1 - DARREN PRINGLE & JOANNE BROTHWELL-PRINGLE
- LOT 2 BLOCK 1 - PAUL & SHELLEY PIZZEL
- LOT 3 BLOCK 1 - STANLEY & CHARLOTTE RUDE
- LOT 4 BLOCK 1 - SHIRLEY, LESLIE, & KRISTIN KUNZ
- LOT 5 BLOCK 1 - CATHY STAPLETON & SHIRLEY STAPLETON
- LOT 6 BLOCK 1 - CATHY STAPLETON & SHIRLEY STAPLETON
- LOT 7 BLOCK 1 - SHIRLEY STAPLETON & SHIRLEY STAPLETON
- LOT 8 BLOCK 1 - SHIRLEY STAPLETON & SHIRLEY STAPLETON
- LOT 9 BLOCK 1 - SHIRLEY STAPLETON & SHIRLEY STAPLETON
- LOT 10 BLOCK 1 - SHIRLEY STAPLETON & SHIRLEY STAPLETON
- LOT 11 BLOCK 1 - SHIRLEY STAPLETON & SHIRLEY STAPLETON
- LOT 12 BLOCK 1 - SHIRLEY STAPLETON & SHIRLEY STAPLETON
- LOT 13 BLOCK 1 - SHIRLEY STAPLETON & SHIRLEY STAPLETON
- LOT 14 BLOCK 1 - SHIRLEY STAPLETON & SHIRLEY STAPLETON
- LOT 15 BLOCK 1 - SHIRLEY STAPLETON & SHIRLEY STAPLETON
- LOT 16 BLOCK 1 - SHIRLEY STAPLETON & SHIRLEY STAPLETON
- LOT 17 BLOCK 1 - SHIRLEY STAPLETON & SHIRLEY STAPLETON
- LOT 18 BLOCK 1 - SHIRLEY STAPLETON & SHIRLEY STAPLETON
- LOT 19 BLOCK 1 - SHIRLEY STAPLETON & SHIRLEY STAPLETON
- LOT 1 BLOCK 2 - PRINGLE DEVELOPMENTS INC.
- LOT 2 BLOCK 2 - JOHN SCHNEIDER
- LOT 3 BLOCK 2 - STANLEY & CHARLOTTE RUDE
- LOT 4 BLOCK 2 - SHIRLEY, LESLIE, & KRISTIN KUNZ
- LOT 5 BLOCK 2 - RODNEY & BONNIE NEUFFELD
- LOT 6 BLOCK 2 - CORNELL & ANDRE NEUDORF
- LOT 7 BLOCK 2 - JOANNE LAIDLAW
- LOT 8 BLOCK 2 - DAVID & SUSAN FEHR
- LOT 9 BLOCK 2 - JASON & DENISE WALDNER
- LOT 10 BLOCK 2 - DARYL & CORALEA HAUN
- LOT 11 BLOCK 2 - DARYL & CORALEA HAUN
- LOT 12 BLOCK 2 - ROBERT & JUDY HEUSDENS
- LOT 13 BLOCK 2 - ROBERT & JUDY HEUSDENS
- LOT 14 BLOCK 2 - MICHAEL & KIM WALD
- LOT 15 BLOCK 2 - KENNETH WALD & MICHELLE MACALUAY
- LOT 16 BLOCK 2 - JOHN EUSTACE
- LOT 17 BLOCK 2 - PRINGLE DEVELOPMENTS INC.
- LOT 18 BLOCK 2 - PRINGLE DEVELOPMENTS INC.
- LOT 19 BLOCK 2 - PRINGLE DEVELOPMENTS INC.

LAKESIDE SUBDIVISION
NW 13-42-21-2

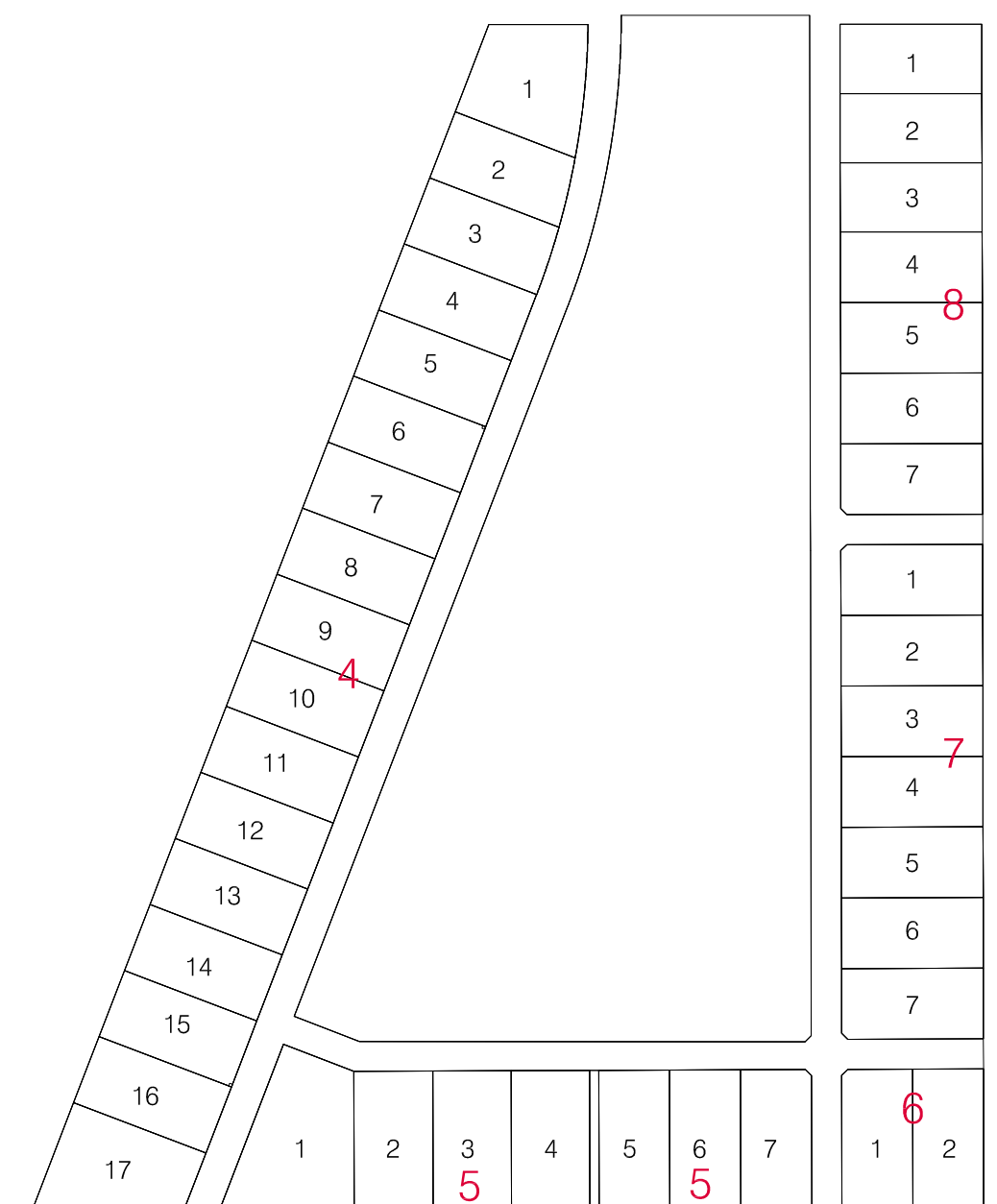

- LOT 1 BLOCK 4 - ST. BRIEUX REALTY INC.
- LOT 2 BLOCK 4 - ST. BRIEUX REALTY INC.
- LOT 3 BLOCK 4 - TODD & MICHELLE SHEREMETA
- LOT 4 BLOCK 4 - ELLA SAMBOUR-BERSCHIED
- LOT 5 BLOCK 4 - DEAN & CORINNE THOMAS
- LOT 6 BLOCK 4 - ARNOLD & CONNIE COTE
- LOT 7 BLOCK 4 - ROGER & CHERYL BORTS
- LOT 8 BLOCK 4 - DONALD & JUDITH HAWES
- LOT 9 BLOCK 4 - DONALD & JUDITH HAWES
- LOT 10 BLOCK 4 - DONALD & JUDITH HAWES
- LOT 11 BLOCK 4 - DAD'S NUTRITION CENTRE LTD.
- LOT 12 BLOCK 4 - DEAN & SARAH BIGELOW
- LOT 13 BLOCK 4 - BRUCE & DENISE BORTS
- LOT 14 BLOCK 4 - ST. BRIEUX REALTY INC.
- LOT 15 BLOCK 4 - ST. BRIEUX REALTY INC.
- LOT 16 BLOCK 4 - HARRY & MAUREEN TAYLOR
- LOT 17 BLOCK 4 - CARY SERVISS
- LOT 1 BLOCK 5 - KEN & PATRICIA HILL
- LOT 2 BLOCK 5 - ST. BRIEUX REALTY INC.
- LOT 3 BLOCK 5 - JEFF & CHERYL HUNT
- LOT 4 BLOCK 5 - JEFF & KENDRA GRAY
- LOT 5 BLOCK 5 - ST. BRIEUX REALTY INC.
- LOT 6 BLOCK 5 - MARILYN & KORY SCHNELLECK
- LOT 7 BLOCK 5 - ST. BRIEUX REALTY INC.
- LOT 1 BLOCK 6 - MILTON & ROSEMARY CROSWELL
- LOT 2 BLOCK 6 - ST. BRIEUX REALTY INC.
- LOT 1 BLOCK 7 - ST. BRIEUX REALTY INC.
- LOT 2 BLOCK 7 - ST. BRIEUX REALTY INC.
- LOT 3 BLOCK 7 - ST. BRIEUX REALTY INC.
- LOT 4 BLOCK 7 - ST. BRIEUX REALTY INC.
- LOT 5 BLOCK 7 - ST. BRIEUX REALTY INC.
- LOT 6 BLOCK 7 - ST. BRIEUX REALTY INC.
- LOT 7 BLOCK 7 - ST. BRIEUX REALTY INC.
- LOT 1 BLOCK 8 - ST. BRIEUX REALTY INC.
- LOT 2 BLOCK 8 - ST. BRIEUX REALTY INC.
- LOT 3 BLOCK 8 - ST. BRIEUX REALTY INC.
- LOT 4 BLOCK 8 - ST. BRIEUX REALTY INC.
- LOT 5 BLOCK 8 - ST. BRIEUX REALTY INC.
- LOT 6 BLOCK 8 - ST. BRIEUX REALTY INC.
- LOT 7 BLOCK 8 - ST. BRIEUX REALTY INC.

- LOT 1 BLOCK 1 - FAGNOLI FARMS
- LOT 2 BLOCK 1 - DANIELLE & OLIVIER LAROUCHE
- LOT 3 BLOCK 1 - PAUL & JUDY FAGNOLI
- LOT 4 BLOCK 1 - ED & JAN FAGNOLI
- LOT 5 BLOCK 1 - BLUESKY DEVELOPMENTS INC.
- LOT 6 BLOCK 1 - BETA BOURGAULT
- LOT 7 BLOCK 1 - GORDON ROSS & JOCELYN BOSKILL
- LOT 8 BLOCK 1 - BLUESKY DEVELOPMENTS INC.
- LOT 9 BLOCK 1 - KENT & RICHELLE ROGERS
- LOT 10 BLOCK 1 - JEFF & ENA MAULYER
- LOT 11 BLOCK 1 - BLUESKY DEVELOPMENTS INC.
- LOT 12 BLOCK 1 - BLUESKY DEVELOPMENTS INC.
- LOT 13 BLOCK 1 - BLUESKY DEVELOPMENTS INC.
- LOT 14 BLOCK 1 - DARREN & CHRISTINA GARCHINSKI
- LOT 15 BLOCK 1 - JOSEPH BOURGAULT
- LOT 16 BLOCK 1 - DENIS COQUET
- LOT 17 BLOCK 1 - GREGORY & JENNINE RHEAUME
- LOT 18 BLOCK 1 - GREGORY & JENNINE RHEAUME
- LOT 19 BLOCK 1 - BLUESKY DEVELOPMENTS INC.
- LOT 20 BLOCK 1 - DARREN & CHRISTINA GARCHINSKI
- LOT 21 BLOCK 1 - DONALD & LUCILLE ASSIF
- LOT 22 BLOCK 1 - BLUESKY DEVELOPMENTS INC.
- LOT 23 BLOCK 1 - BLUESKY DEVELOPMENTS INC.
- LOT 24 BLOCK 1 - BLUESKY DEVELOPMENTS INC.
- LOT 25 BLOCK 1 - BLUESKY DEVELOPMENTS INC.
- LOT 26 BLOCK 1 - BLUESKY DEVELOPMENTS INC.
- LOT 27 BLOCK 1 - BLUESKY DEVELOPMENTS INC.
- LOT 28 BLOCK 1 - BLUESKY DEVELOPMENTS INC.
- LOT 29 BLOCK 1 - BLUESKY DEVELOPMENTS INC.
- LOT 1 BLOCK 2 - BLUESKY DEVELOPMENTS INC.
- LOT 2 BLOCK 2 - BLUESKY DEVELOPMENTS INC.
- LOT 3 BLOCK 2 - BLUESKY DEVELOPMENTS INC.
- LOT 4 BLOCK 2 - BLUESKY DEVELOPMENTS INC.
- LOT 5 BLOCK 2 - BLUESKY DEVELOPMENTS INC.
- LOT 6 BLOCK 2 - BLUESKY DEVELOPMENTS INC.
- LOT 7 BLOCK 2 - JAY & JENNIFER WEIKL
- LOT 8 BLOCK 2 - JAG BUILDERS LTD.
- LOT 9 BLOCK 2 - JAG BUILDERS LTD.
- LOT 10 BLOCK 2 - KELVIN & YVONNE STEVENSON
- LOT 1 BLOCK 3 - SHARON KLEIBOER
- LOT 2 BLOCK 3 - GERARD & LOUISE BOURGAULT
- LOT 1 BLOCK 4 - BLUESKY DEVELOPMENTS INC.
- LOT 2 BLOCK 4 - RON & PAUL ORR
- LOT 3 BLOCK 4 - BLUESKY DEVELOPMENTS INC.
- LOT 4 BLOCK 4 - BLUESKY DEVELOPMENTS INC.
- LOT 5 BLOCK 4 - BLUESKY DEVELOPMENTS INC.
- LOT 6 BLOCK 4 - KEITH REINEKE
- LOT 7 BLOCK 4 - BLUESKY DEVELOPMENTS INC.
- LOT 8 BLOCK 4 - BLUESKY DEVELOPMENTS INC.
- LOT 9 BLOCK 4 - BLUESKY DEVELOPMENTS INC.
- LOT 10 BLOCK 4 - BLUESKY DEVELOPMENTS INC.
- LOT 11 BLOCK 4 - DARREN HENDERSON & CHARLENE BEHM HENDERSON
- LOT 12 BLOCK 4 - AARON & SHANNON JOHNSON
- LOT 13 BLOCK 4 - AARON & SHANNON JOHNSON
- LOT 14 BLOCK 4 - MICHAEL TUMBACH & ANGELA STEFANIUK
- LOT 1 BLOCK 6 - THEODORE & KIM GERWING
- LOT 2 BLOCK 6 - BLUESKY DEVELOPMENTS INC.
- LOT 3 BLOCK 6 - BLUESKY DEVELOPMENTS INC.
- LOT 4 BLOCK 6 - SEAN, KELLY & YVONNE DAY
- LOT 5 BLOCK 6 - BLUESKY DEVELOPMENTS INC.
- LOT 6 BLOCK 6 - ERIC & GLORIA LINDRIGAN
- LOT 7 BLOCK 6 - RONALD & DEBBIE YOUNG
- LOT 8 BLOCK 6 - RONALD & DEBBIE YOUNG
- LOT 9 BLOCK 6 - GARY & DIANE SVENKESON
- LOT 10 BLOCK 6 - WENDALL & WILMA KOVACS
- LOT 11 BLOCK 6 - TROY & JULIAN YOUNG
- LOT 12 BLOCK 6 - DAVID ZAWADA & SHERI CROZIER
- LOT 13 BLOCK 6 - WADE & DAWN ROLLER
- LOT 14 BLOCK 6 - JAMIE LOUISEIZE
- LOT 15 BLOCK 6 - COREY & JODY SNIDER
- LOT 16 BLOCK 6 - RANDY YAMLIK
- LOT 1 BLOCK 7 - BLUESKY DEVELOPMENTS INC.
- LOT 2 BLOCK 7 - GARY KEVIN STONEMAN
- LOT 3 BLOCK 7 - TRAVIS & TRACY LAYCOCK
- LOT 4 BLOCK 7 - DAVID ARCHIBALD
- LOT 5 BLOCK 7 - BLUESKY DEVELOPMENTS INC.
- LOT 6 BLOCK 7 - DANIEL & JENNIFER DESAGNE
- LOT 7 BLOCK 7 - KELVIN & YVONNE STEVENSON
- LOT 8 BLOCK 7 - BLUESKY DEVELOPMENTS INC.
- LOT 9 BLOCK 7 - BLUESKY DEVELOPMENTS INC.
- LOT 1 BLOCK 8 - ALLAN & KATHY OAR
- LOT 2 BLOCK 8 - DONALD & DIANNE SCHLACHTER
- LOT 3 BLOCK 8 - BRENT & MICHELLE STAMMEN
- LOT 4 BLOCK 8 - RONALD DUKE
- LOT 5 BLOCK 8 - RONALD GRAHAM
- LOT 6 BLOCK 8 - RONALD GRAHAM
- LOT 7 BLOCK 8 - GREGORY & GLORIA L'HENAFF
- LOT 8 BLOCK 8 - TERRY & DAWN HITCHINGS
- LOT 9 BLOCK 8 - HAL & ADAM SWARTZ
- LOT 10 BLOCK 8 - GEORDE & TARA NELSON
- LOT 11 BLOCK 8 - CRAIG & JOCELYNE CUMMING
- LOT 12 BLOCK 8 - KENTON & MADINE REMENDA

